

3.4
mm

Metal
M
五金



ZWBMD003003

齿轮箱规格 Gearbox specifications

外径 Outer diameter	3mm	轴承 Bearing	烧结轴承 Porous Bearing
材质 Material	五金 Metal	轴向窜动 Axial endplay	≤0.3mm
旋转方向 Direction of rotation	cc & ccw	输出轴径向负载 Radial loading on output shaft	≤0.3N
齿轮箱回程差 Gear backlash	≤3°	工作温度 Operating temperature range	-20 ~ +85°C

齿轮级数 Gearbox stages

	1	2	3	4
减速比 Reduction ratio	5	25	125	625
最大容许扭力 (gf.cm max) Max rated torque of gear box	50	50	50	50
瞬间容许力矩 (gf.cm max) Instant torque of gear box	150	150	150	150
齿轮箱效率 Gearbox efficiency	85	73	65	58
长度 Length	6	7.5	9	10.5

技术插图 | Technical illustrations

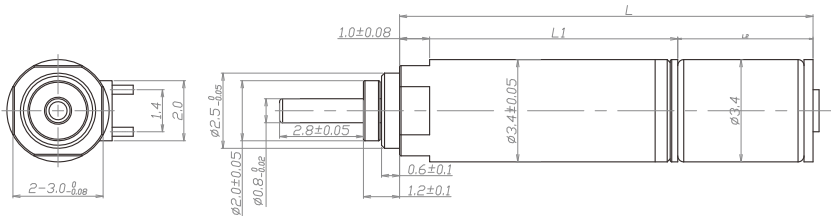

马达规格参数 Motor specifications

马达(可选择) Motors(Optional)	空心杯电机、步进电机 Coreless motor, Stepper motor	输入速度 Input speed	≤10000rpm
电压(可选择) Voltage(Optional)	1.5-5V	电流 Current	50MA max

型号 Model	Rated Speed 额定转速	Max Rated Torque 额定容许力矩	Max Instant Torque 瞬间容许力矩	Reduction ratio 减速比	Length 减速箱长 L1	Overall Length 总长 L
	rpm	gf.cm	gf.cm		mm	mm
ZWBMD003003-5	300.0	50	150	5	6.0	10.75
ZWBMD003003-25	60.0	50	150	25	7.5	12.25
ZWBMD003003-125	12.0	50	150	125	9.0	13.75
ZWBMD003003-625	2.4	50	150	625	10.5	15.25

注：可根据客户要求定制 Can customize product as requirements